

Plot Wood Hill Park, Portishead, BS20 7DR
Offers In Excess Of £175,000

GOODMAN
& LILLEY



THE INDEPENDENT SALES, LETTINGS & LAND AGENTS

Plot Wood Hill Park, Portishead, BS20 7DR

Goodman & Lilley land and new homes are delighted to welcome to the market a single building plot with outline planning permissions for the erection of a 4-bedroom split-level house situated on the highly regarded Woodhill Park residential development. Ref 21/P/1267/OUT

Offering an extremely rare opportunity to design, create and built your very own dream home within one of Portishead's most prestigious locations.

Situated within a prime position within easy reach of the many shops, boutiques, bars, restaurants and facilities of Portishead High Street, including a Waitrose on the marina. It also offers a large number of outdoor activities both water based, with the Portishead Sailing Club and Portishead Marina, and outdoor pursuits such as the open-air lido and parks within North Somerset. The M5 motorway network is accessible via junction 19 allowing easy access to both north and south. Bristol International Airport, located in North Somerset, offers flights to European and some long-haul destinations.

- Single Building Plot
- Outline Planning Permission
- Highly Regarded Address
- Planning Ref: 21/P/1267/OUT
- Unique Opportunity
- Call For Further Details

Portishead

Rembrandt House, 36 High Street, Portishead
North Somerset, BS20 6EN

01275 430 440

www.goodmanlilley.co.uk

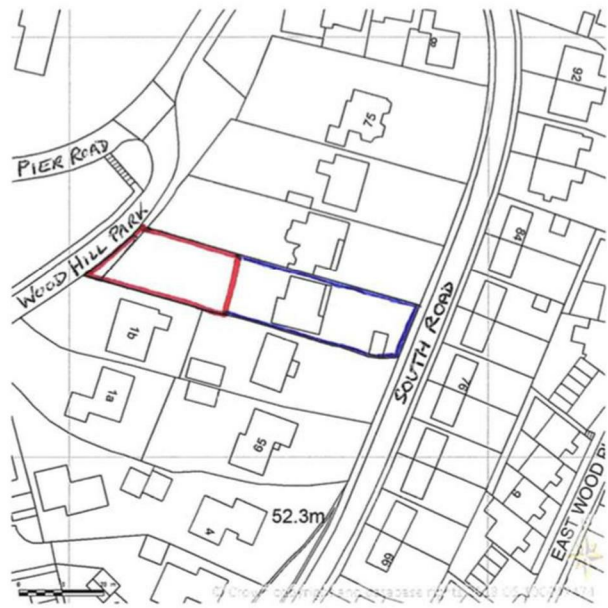

Supplied by Streetwise Maps Ltd
www.streetwise.net





These particulars are for general guidance only. They do not form or constitute any part of an offer or contract. Goodman & Lilley has not carried out structural surveys of the property. The services, appliances or specific fittings mentioned in these details have not been tested. Every attempt is made to ensure accuracy, however all photographs, measurements, floor plans and distances are for illustrative purposes only. They must not be relied upon when purchasing carpets and or other fixtures and fittings. Lease details, service charges and ground rents are given as a guide only. They should be checked and confirmed by a licensed solicitor prior to exchange of contracts. The copyright of all details, photographs and floor plans remain exclusive to Goodman & Lilley.